

Vanity Unit

 4x screws

 2x Handle Bolts

If you have purchased multiple units please see the multiple unit instruction sheet, referring back to this sheet at step 1 and 5 for vanity unit instructions.

 2x Handles

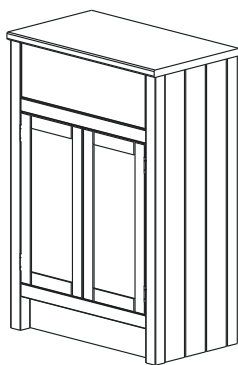

3 After all necessary plumbing is completed attach the worktop using the screws provided, screwing up through the worktop blocks into the work top. When fixing the worktop ensure there is equal overhang (approx. 5mm) at each side and that the work top is flush with the back of the unit.

See worktop cutting instruction for more information on how to measure and cut your worktop to fit. Make sure any cutting required for basin installation is completed before attaching the worktop, this should be done following the basin manufactures guide and templates.

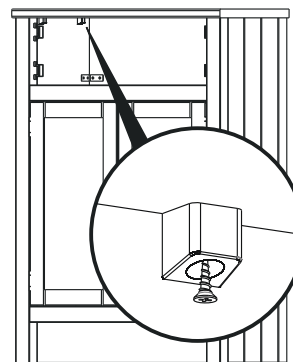

1

Remove the fascia by gently pulling it away from the rest of the unit.

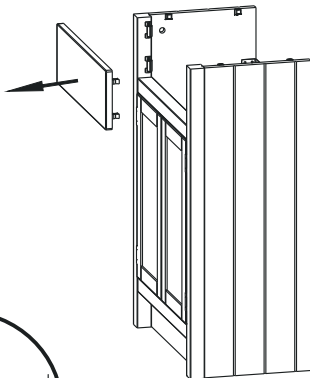

2

Place the unit in it's required position, use a spirit level to make sure it is level and plumb. Fix the unit in place using suitable wall fixings (not supplied), screw through the L-shape brackets to secure the unit to the wall.

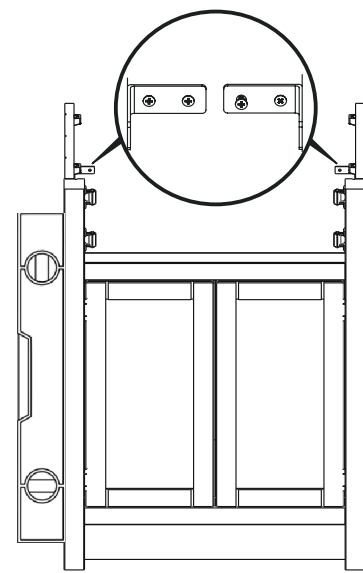

It is good practice to seal post ends on both side panels with a good quality sealant.

NOTE:- It is good practice to fit all pipework and plumbing before fixing the unit to the wall to enable easier installation and fitting.
IMPORTANT make sure that you seal any raw edges after cutting with a water repellant sealant to prevent water ingress.

5

Once you have decided on your positioning of the handle's, using a pencil and tape measure to mark out the required position on the rear of the door. Check positioning with front details.

You may want to place a piece of scrap wood behind the door to prevent any breakout. Drill holes using a suitable size drill bit. Attach the handle using 1x handle bolt per door. Fit the basin following manufactures instructions

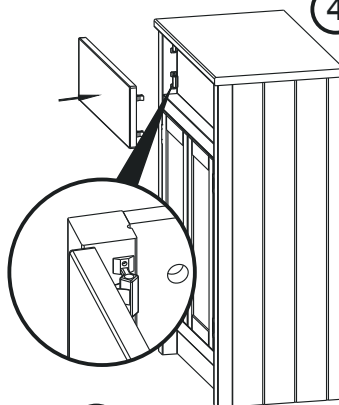

4

Reattach the fascia back to the unit by lining up the spring catches and gently pushing into place. Make sure an cutting required for basin installation is completed following basin manufactures guides and templates before attaching the fascia.

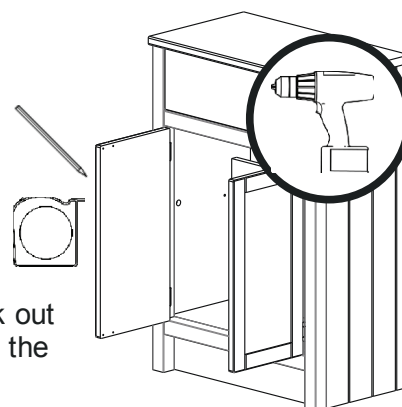

Tools required (not supplied)

Pencil

Cross head screwdriver

Tape Measure

Spirit level

Drill and drill bits

Required when securing the cabinet to a wall. Use an appropriate size bit to match the wall fixing chosen (wall screws and fixings not supplied)

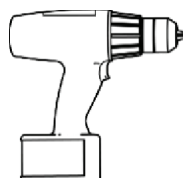

IMPORTANT

We recommend that you read the sealant packaging for the curing time. do not use until the sealant is set.

If you are at all unsure of any part of the instructions shown in this document we recommend that you contact a reputable qualified trades person.

Product Aftercare

We recommend cleaning with a soft damp cloth and mild soap solution.

Do not use cream cleaners or cleaners containing bleach.

Do not scrub or scour.

Do not use abrasive cleaning agents.

Do not use solvent based cleaners.

If a polish is to be used, use wax free polish.

Do not allow pools of water to remain standing on the surfaces

Before you start carefully read the instructions.

Check the pack and make sure all the components are included. When you are ready to start make sure you have the right tools to hand, plenty of space and a clean dry area for building. Don't rush, read the instructions first and run through them before you begin.

Keep fittings together to avoid loss. Do not over tighten screws or bolts.

CLEANING Use mild soap and water only. Do not use washing powders or any other types of abrasive cleaner. See aftercare instructions.



If a part is missing or damaged, please call 01535 613 830. Please have your instruction guide ready.

W30/345

220914

Multiple Unit Assembly



4x screws per unit

Refer to unit instructions at step 1 and 5 for instruction specific to each unit.

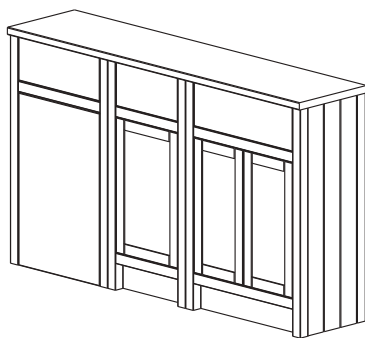

This is an example arrangement for illustration purposes only

1

Remove any fascias, front panels and drawers from the units following the instructions provided with the individual unit.

WC unit - step 1

Vanity unit - step 1

Base unit - step 1

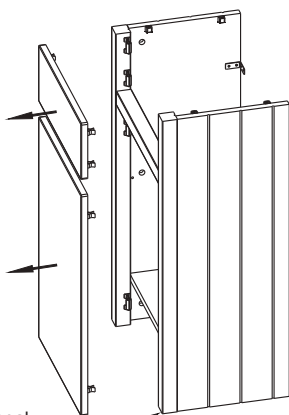

It is good practice to seal post ends on all side panels with a good quality sealant.

2

Decide on the arrangement of the units to best suit your bathroom.

NOTE:- It is good practice to fit all pipework and plumbing before fixing the unit to the wall to enable easier installation and fitting. **IMPORTANT** make sure that you seal any raw edges after cutting with a water repellent sealant to prevent water ingress.

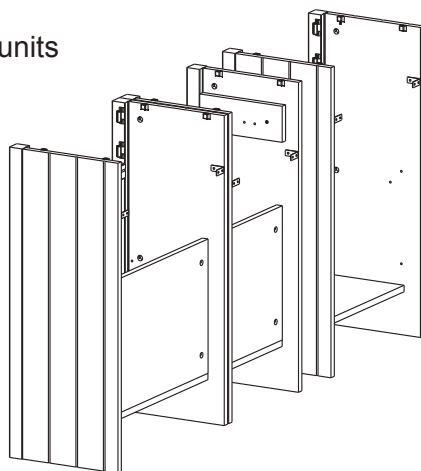

3

Place the units in their required position, use a spirit level to make sure the units are level and plumb. Fix them in place using suitable wall fixings (not supplied), screw through the L-shape brackets to secure the unit to the wall. We would recommend attaching one at a time making sure the following is pushed right up against the previous, you may wish to use a clamp to hold the unit in place, using reasonable padding to reduce damage. You may wish to add further fixings through the side panels to join the units together. We would recommend hiding these behind the loose shelves etc.

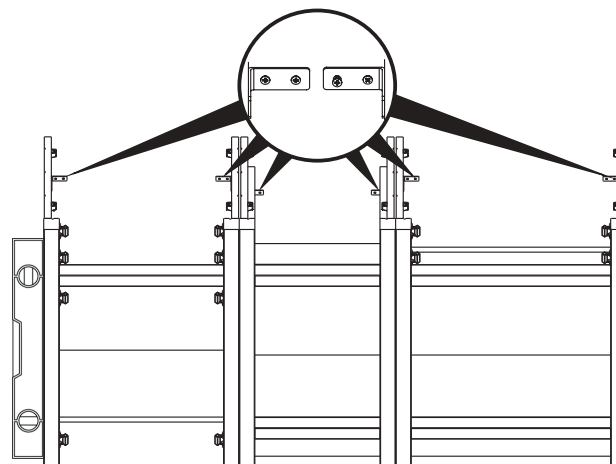

4

Making sure all necessary plumbing is completed attach the worktop using the screws provided, screwing up through the worktop blocks of each unit into the worktop.

When fixing the worktop ensure there is equal overhang at each side (approx. 5mm) and that the worktop is flush with the back of the unit.

See worktop cutting instruction for more information on how to measure and cut your worktop to fit.

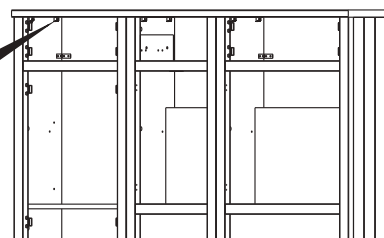
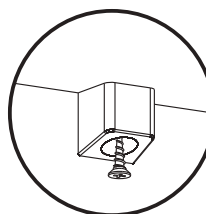

5

Refer to the single unit instructions supplied with each piece to finish off individual units by reattaching any fascias, front panels and drawers.

WC unit - step 4

Vanity unit - step 4 to 5

Base unit - step 4 to 5

Cutting The Worktop

Work top supplied is to fit a multiple unit assembly of 1x WC unit, 1x 400 Base unit and 1x Vanity unit. If your assembly differs you will need to trim the work top to fit your assembly.

1

Measure the width of the assembly from the outside of the front legs.

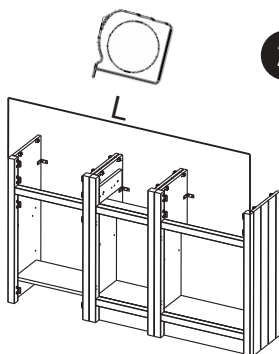

2

Mark out the length of worktop required and cut following worktop manufactures instructions supplied with the worktop.

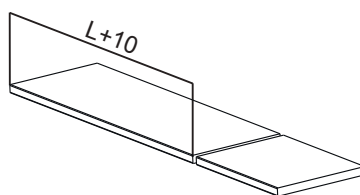

3

Finish the cut edge of the worktop following manufactures instructions supplied with the worktop.

If you are at all unsure of any part of the instructions contact a reputable qualified trades person.

Base Unit



4x screws



2x Handle Bolts

If you have purchased multiple units please see the multiple unit instruction sheet, referring back to this sheet at step 1 and 5 for base unit instructions.



2x Handles

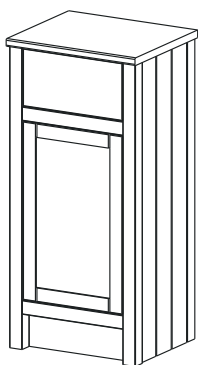

1 Remove the draw from the unit.

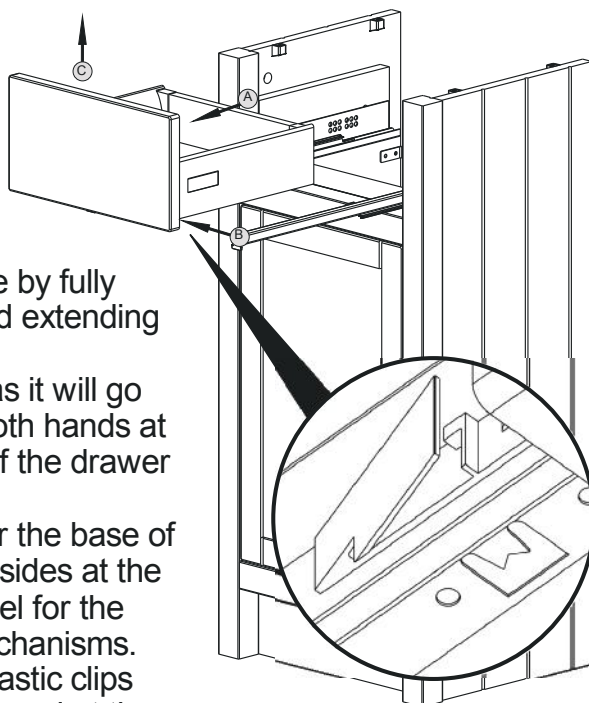

This is done by fully opening and extending the drawer unit as far as it will go (A). With both hands at each side of the drawer unit reach under the base of the drawer sides at the front and feel for the release mechanisms. Push the plastic clips inwards (B) and at the same time lift the drawer unit up clear of the runners (C).

NOTE:- It is good practice to fit all pipework and plumbing before fixing the unit to the wall to enable easier installation and fitting.

IMPORTANT make sure that you seal any raw edges after cutting with a water repellant sealant to prevent water ingress.

Tools required (not supplied)

Pencil



Cross head screwdriver



Tape Measure



Spirit level

Drill and drill bits

Required when securing the cabinet to a wall. Use an appropriate size bit to match the wall fixing chosen (wall screws and fixings not supplied)

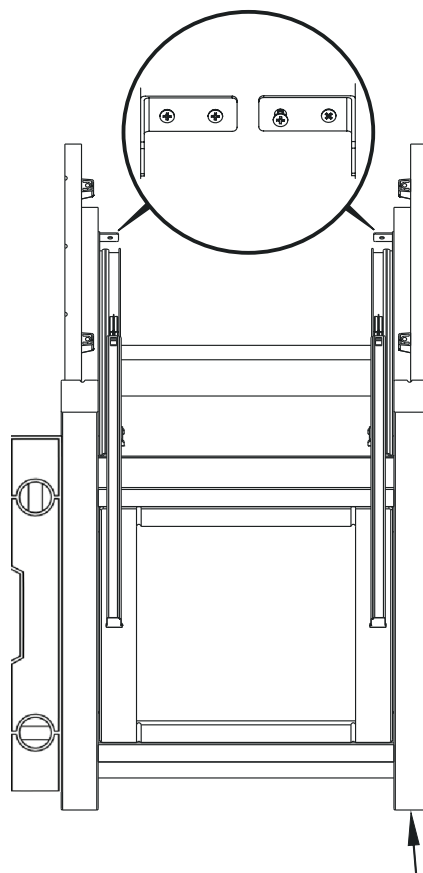

It is good practice to seal post ends on both side panels with a good quality sealant.

IMPORTANT

We recommend that you read the sealant packaging for the curing time. do not use until the sealant is set.

If you are at all unsure of any part of the instructions shown in this document we recommend that you contact a reputable qualified trades person.

Product Aftercare

We recommend cleaning with a soft damp cloth and mild soap solution.

Do not use cream cleaners or cleaners containing bleach.

Do not scrub or scour.

Do not use abrasive cleaning agents.

Do not use solvent based cleaners.

If a polish is to be used, use wax free polish.

Do not allow pools of water to remain standing on the surfaces

Before you start carefully read the instructions.

Check the pack and make sure all the components are included. When you are ready to start make sure you have the right tools to hand, plenty of space and a clean dry area for building. Don't rush, read the instructions first and run through them before you begin.

Keep fittings together to avoid loss. Do not over tighten screws or bolts.

CLEANING Use mild soap and water only. Do not use washing powders or any other types of abrasive cleaner. See aftercare instructions.



If a part is missing or damaged, please call 01535 613 830. Please have your instruction guide ready.

W30/346

220914

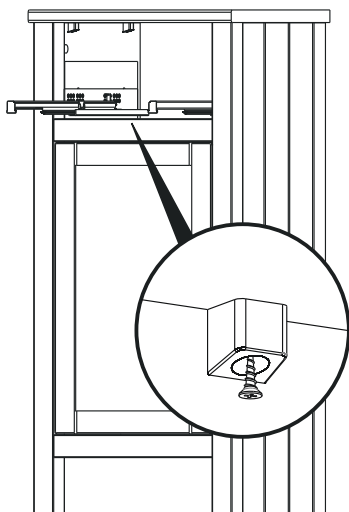

- 3 After all necessary plumbing is completed attach the worktop using the screws provided, screwing up through the worktop blocks into the work top. When fixing the worktop ensure there is equal overhang (approx. 5mm) at each side and that the work top is flush with the back of the unit.
See worktop cutting instruction for more information on how to measure and cut your worktop to fit.

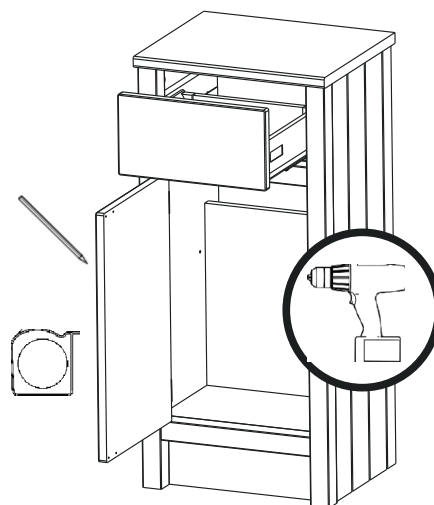

4

To re-attach the drawer to the cabinet extend the drawer runners (A). Then lower the drawer onto the drawer runners (B) and push close until it locks into position (C).

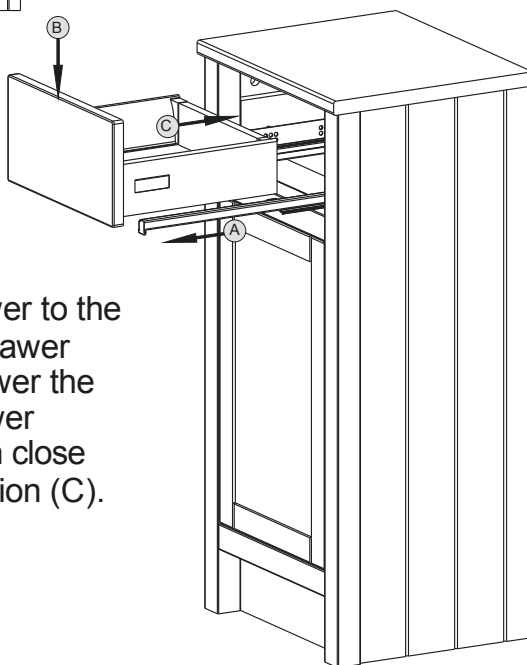

5

Once you have decided on your positioning of the handle's, using a pencil and tape measure mark out the required position on the rear of the door and drawer front. Check positioning with front details. You may want to place a piece of scrap wood behind the door and draw to prevent any breakout when drilling. Drill with a suitable size drill bit. Attach the handles using 1x handle bolt per door.

Adjusting the draw

The draw can be adjusted by following the below instructions.

- 1 Gently remove the plastic cover caps from the drawer sides to reveal the adjustment wheel and screw.
- 2 Please follow the diagrams below to adjust the drawer in both the vertical and horizontal planes. Please note horizontal adjustment can only be made from the RH drawer side.

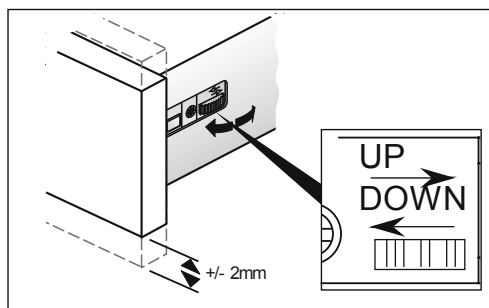

Verticle

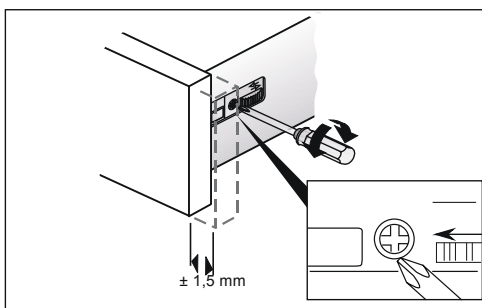

Horizontal

- 3 When adjustment has been made replace the plastic cover caps by gently pushing back into place.

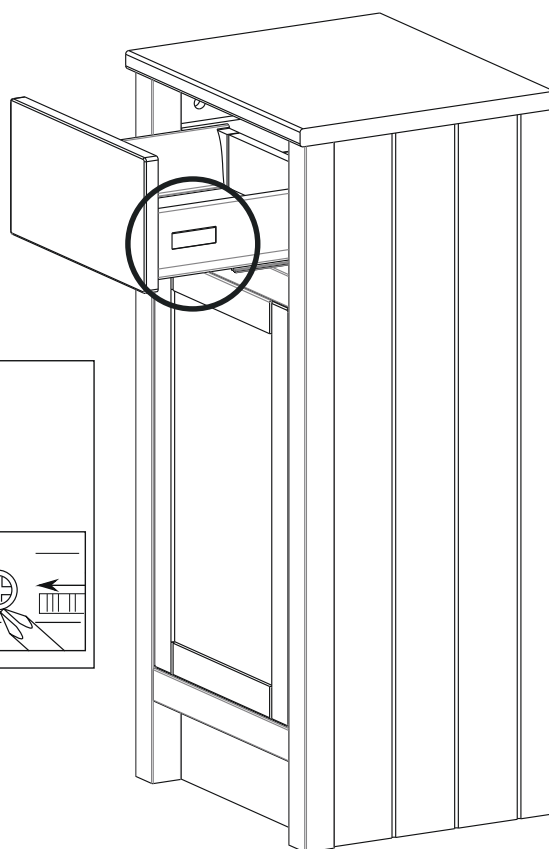

Multiple Unit Assembly



4x screws per unit

Refer to unit instructions at step 1 and 5 for instruction specific to each unit.

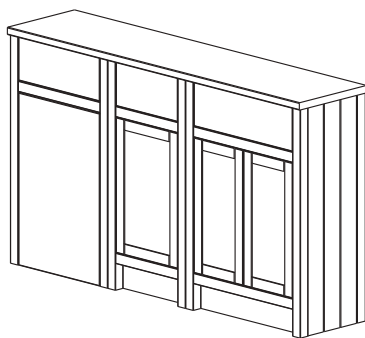

This is an example arrangement for illustration purposes only

1

Remove any fascias, front panels and drawers from the units following the instructions provided with the individual unit.

WC unit - step 1

Vanity unit - step 1

Base unit - step 1

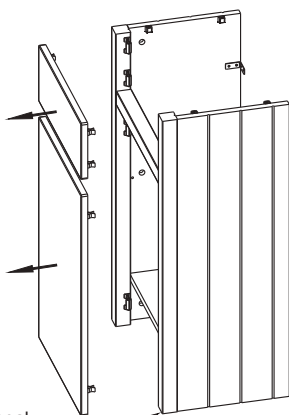

It is good practice to seal post ends on all side panels with a good quality sealant.

2

Decide on the arrangement of the units to best suit your bathroom.

NOTE:- It is good practice to fit all pipework and plumbing before fixing the unit to the wall to enable easier installation and fitting. **IMPORTANT** make sure that you seal any raw edges after cutting with a water repellent sealant to prevent water ingress.

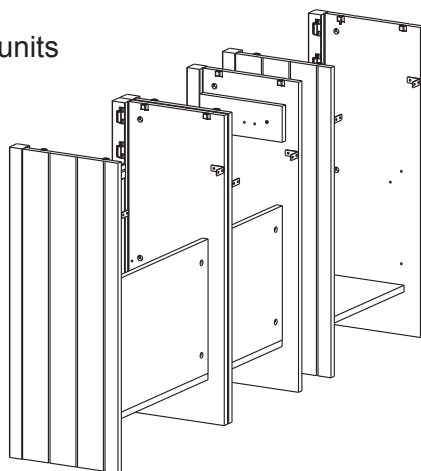

3

Place the units in their required position, use a spirit level to make sure the units are level and plumb. Fix them in place using suitable wall fixings (not supplied), screw through the L-shape brackets to secure the unit to the wall. We would recommend attaching one at a time making sure the following is pushed right up against the previous, you may wish to use a clamp to hold the unit in place, using reasonable padding to reduce damage. You may wish to add further fixings through the side panels to join the units together. We would recommend hiding these behind the loose shelves etc.

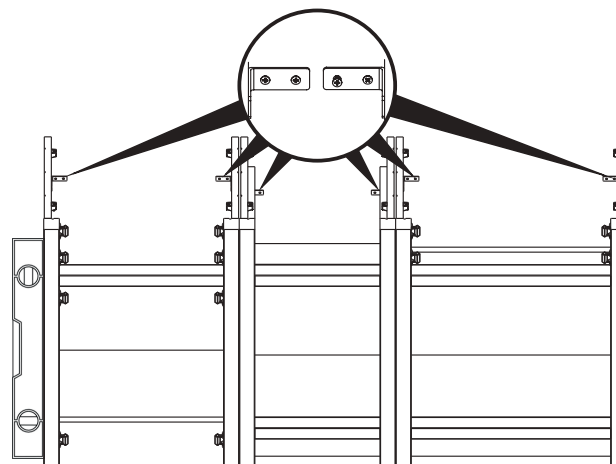

4

Making sure all necessary plumbing is completed attach the worktop using the screws provided, screwing up through the worktop blocks of each unit into the worktop.

When fixing the worktop ensure there is equal overhang at each side (approx. 5mm) and that the worktop is flush with the back of the unit.

See worktop cutting instruction for more information on how to measure and cut your worktop to fit.

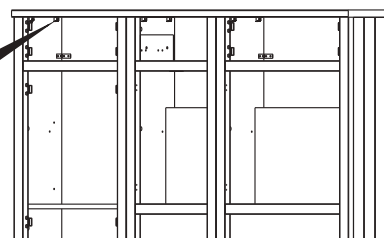
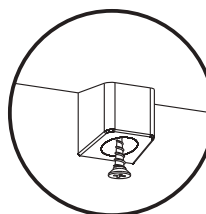

5

Refer to the single unit instructions supplied with each piece to finish off individual units by reattaching any fascias, front panels and drawers.

WC unit - step 4

Vanity unit - step 4 to 5

Base unit - step 4 to 5

Cutting The Worktop

Work top supplied is to fit a multiple unit assembly of 1x WC unit, 1x 400 Base unit and 1x Vanity unit. If your assembly differs you will need to trim the work top to fit your assembly.

1

Measure the width of the assembly from the outside of the front legs.

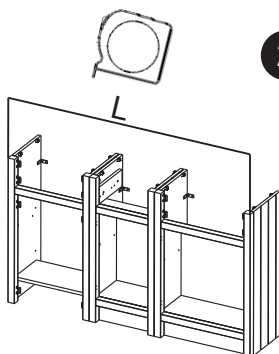

2

Mark out the length of worktop required and cut following worktop manufactures instructions supplied with the worktop.

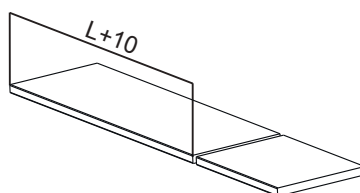

3

Finish the cut edge of the worktop following manufactures instructions supplied with the worktop.

If you are at all unsure of any part of the instructions contact a reputable qualified trades person.

WC Unit

 4x screws

If you have purchased multiple units please see the multiple unit instruction sheet, referring back to this sheet at step 1 and 5 for wc unit instructions.

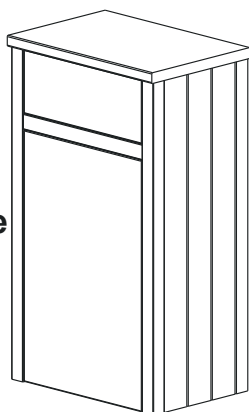

1

Gently remove the fascia and front panel by pulling away from the rest of the unit.

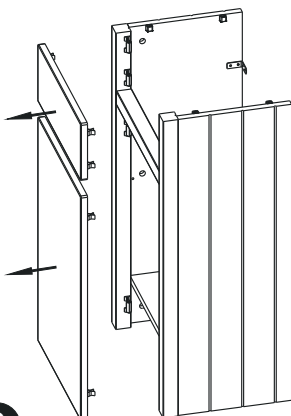

2

Place the unit in its required position, use a spirit level to make sure it is level and plumb. Fix the unit in place using suitable wall fixings (not supplied), screw through the L-shape brackets to secure the unit to the wall.

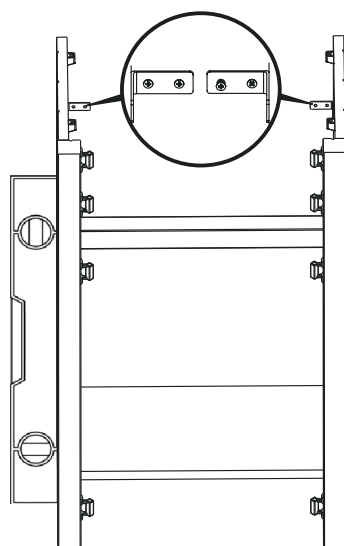

It is good practice to seal post ends on both side panels with a good quality sealant.

NOTE:- It is good practice to fit all pipework and plumbing before fixing the unit to the wall to enable easier installation and fitting.
IMPORTANT make sure that you seal any raw edges after cutting with a water repellent sealant to prevent water ingress.

Tools required (not supplied)

Cross head screwdriver



Spirit level



Drill and drill bits

Required when securing the cabinet to a wall. Use an appropriate size bit to match the wall fixing chosen (wall screws and fixings not supplied)

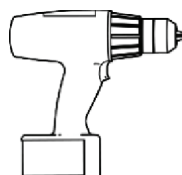

3 After all necessary plumbing is completed attach the worktop using the screws provided, screwing up through the worktop blocks into the work top.
When fixing the worktop ensure there is equal overhang (approx. 5mm) at each side and that the work top is flush with the back of the unit.
See worktop cutting instruction for more information on how to measure and cut your worktop to fit.

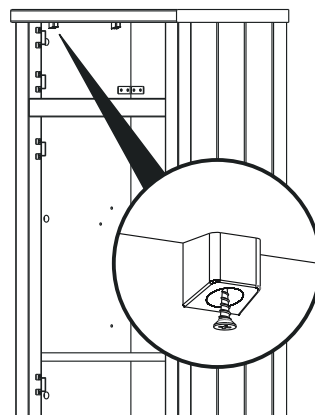

4

Attach the fascia and front panel back to the unit by lining up the spring catches and push into place.
Before reattaching the front panel and fascia back to the unit make sure any drilling and cutting needed to fit the toilet is completed following the toilet manufacturers instructions. We recommend any marking out is done on the back of the pieces and a scrap piece of wood is placed under the board to prevent break through.

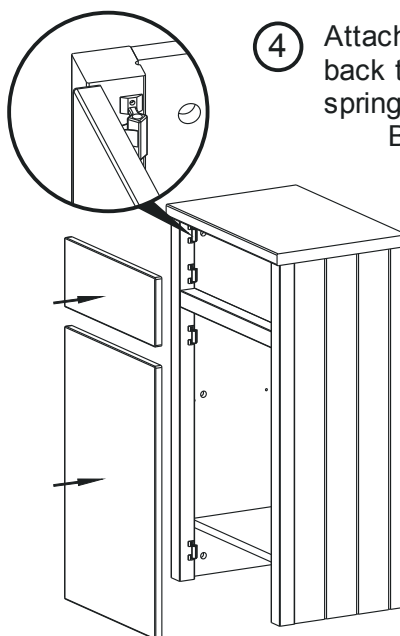

IMPORTANT

We recommend that you read the sealant packaging for the curing time. do not use until the sealant is set.

If you are at all unsure of any part of the instructions shown in this document we recommend that you contact a reputable qualified trades person.

Product Aftercare

We recommend cleaning with a soft damp cloth and mild soap solution.

Do not use cream cleaners or cleaners containing bleach.

Do not scrub or scour.

Do not use abrasive cleaning agents.

Do not use solvent based cleaners.

If a polish is to be used, use wax free polish.

Do not allow pools of water to remain standing on the surfaces

Before you start carefully read the instructions.

Check the pack and make sure all the components are included. When you are ready to start make sure you have the right tools to hand, plenty of space and a clean dry area for building. Don't rush, read the instructions first and run through them before you begin.

Keep fittings together to avoid loss. Do not over tighten screws or bolts.

CLEANING Use mild soap and water only. Do not use washing powders or any other types of abrasive cleaner. See aftercare instructions.



If a part is missing or damaged, please call 01535 613 830. Please have your instruction guide ready.

W30/347

220914

Multiple Unit Assembly



4x screws per unit

Refer to unit instructions at step 1 and 5 for instruction specific to each unit.

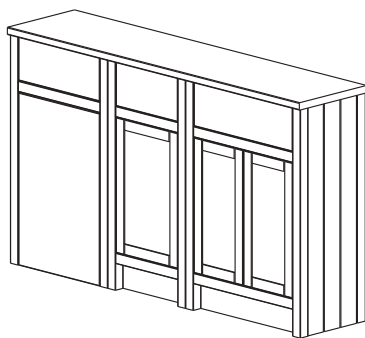

This is an example arrangement for illustration purposes only

1

Remove any fascias, front panels and drawers from the units following the instructions provided with the individual unit.

WC unit - step 1

Vanity unit - step 1

Base unit - step 1

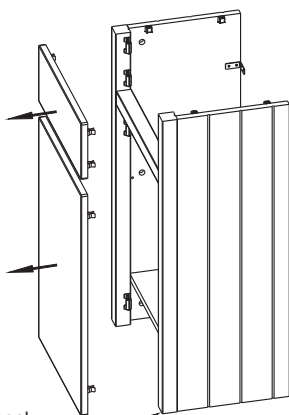

It is good practice to seal post ends on all side panels with a good quality sealant.

2

Decide on the arrangement of the units to best suit your bathroom.

NOTE:- It is good practice to fit all pipework and plumbing before fixing the unit to the wall to enable easier installation and fitting. **IMPORTANT** make sure that you seal any raw edges after cutting with a water repellent sealant to prevent water ingress.

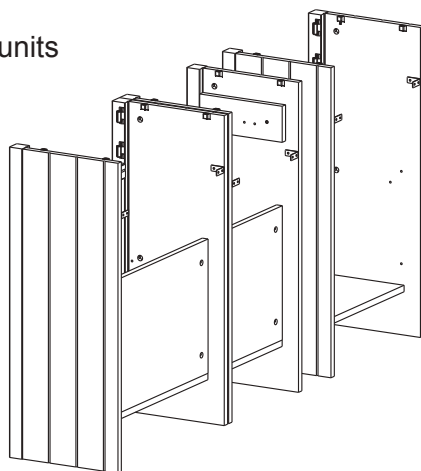

3

Place the units in their required position, use a spirit level to make sure the units are level and plumb. Fix them in place using suitable wall fixings (not supplied), screw through the L-shape brackets to secure the unit to the wall. We would recommend attaching one at a time making sure the following is pushed right up against the previous, you may wish to use a clamp to hold the unit in place, using reasonable padding to reduce damage. You may wish to add further fixings through the side panels to join the units together. We would recommend hiding these behind the loose shelves etc.

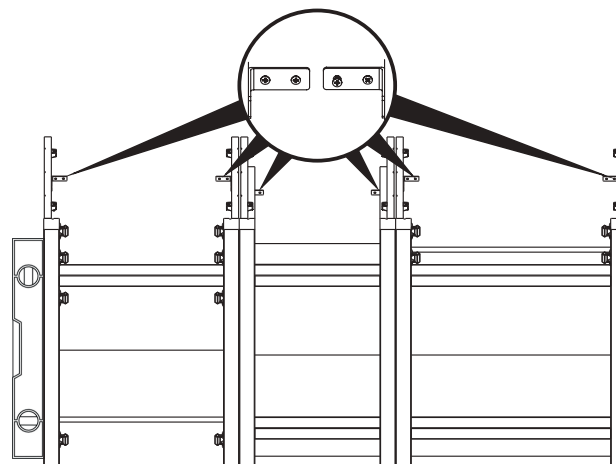

4

Making sure all necessary plumbing is completed attach the worktop using the screws provided, screwing up through the worktop blocks of each unit into the worktop.

When fixing the worktop ensure there is equal overhang at each side (approx. 5mm) and that the worktop is flush with the back of the unit.

See worktop cutting instruction for more information on how to measure and cut your worktop to fit.

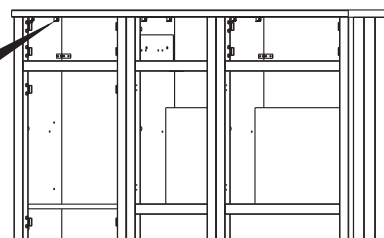
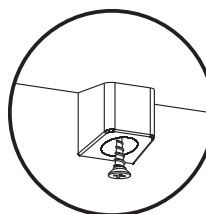

5

Refer to the single unit instructions supplied with each piece to finish off individual units by reattaching any fascias, front panels and drawers.

WC unit - step 4

Vanity unit - step 4 to 5

Base unit - step 4 to 5

Cutting The Worktop

Work top supplied is to fit a multiple unit assembly of 1x WC unit, 1x 400 Base unit and 1x Vanity unit. If your assembly differs you will need to trim the work top to fit your assembly.

1

Measure the width of the assembly from the outside of the front legs.

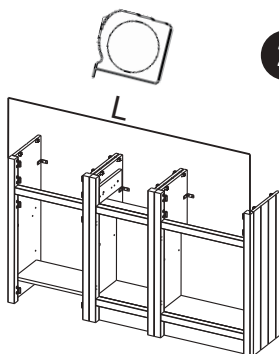

2

Mark out the length of worktop required and cut following worktop manufactures instructions supplied with the worktop.

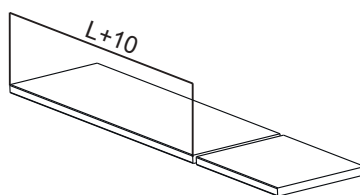

3

Finish the cut edge of the worktop following manufactures instructions supplied with the worktop.

If you are at all unsure of any part of the instructions contact a reputable qualified trades person.